



郑州高德机械设备有限公司
Gaode Equipment Co., Ltd.

地址 ADD: 郑州市金水区丰庆路 4 号院 14 号楼 9 号

邮编 P.C.:450053

No.9, Building 14, Yard No.4, Fengqing Road, Jinshui District, Zhengzhou, Henan China

网站 Web: www.gaodetec.com

邮箱 E-Mail: info@gaodetec.com

电话 TEL.:+86-371-55951210

传真 FAX:+86-371-55951210

GGP800/1200/200PI-D Grout Station



Description

GGP800/1200/200PI D grout station is a combination of mixer, agitator and grout pump in one plant. It is mainly used in highway, railway, hydropower, construction, mining and other ground and underground construction.

High speed vortex mixer ensures mix quickly and evenly. Water, cement or bentonite is quickly mixed into a homogeneous slurry. Then the mixed slurry was delivered to the agitator. Grout pump injects from the mixing drum (storage tank). This ensures a continuous mixing and grouting operations. The grouting plant is full hydraulic drive with diesel engine. Grouting pressure and displacement is step-less adjustable. Compact size and it is easy to operate. It also takes up a small space.



郑州高德机械设备有限公司 Gaode Equipment Co., Ltd.

地址 ADD: 郑州市金水区丰庆路 4 号院 14 号楼 9 号 邮编 P.C.:450053
No.9, Building 14, Yard No.4, Fengqing Road, Jinshui District, Zhengzhou, Henan China
网站 Web: www.gaodetec.com 邮箱 E-Mail: info@gaodetec.com
电话 TEL.:+86-371-55951210 传真 FAX:+86-371-55951210

Feature

- 55KW air cooling diesel engine as the power, it is suitable for field construction
- Pump output is 0-200L/min. Pump pressure is 0-5Mpa. All step-less adjustable.
- Simple structure, light weight, easy maintenance
- Double-cylinder and single-acting grouting pump: grouting continuous and pulse small.
- The latest improvement design of valve chamber: It is quickly convenient cleaning.
- Grouting pump outlet is equipped with buffer. This can further reduce the grouting pressure fluctuations.
- Delivery with special tools. This can ensure change the pistons rapidly, reduce the time of replacing.
- Less spare parts ensure low maintenance costs
- High speed vortex mixer ensures mix quickly and evenly.
- Mixer and agitator switch by using squeeze handle, it is safe, reliable and easy to operate
- Mixer and agitator use Stainless steel material.

Applications

- **Civil engineering** - dam, tunnel, subway, mine, soil nailing wall, curtain, anchor, cable trench and anchor grouting;
- **Building structure** - building and bridge repair, foundation reinforcement, slope support, soil compaction, rock grouting;
- **Engineering** - underwater foundation, offshore platform, coast foundation grouting reinforcement
- **Mine application** - roadway reinforcement, backfill, waterproof grouting.
- Acted as a grouting plant in the Pipe Jacking Machine

Model Definition

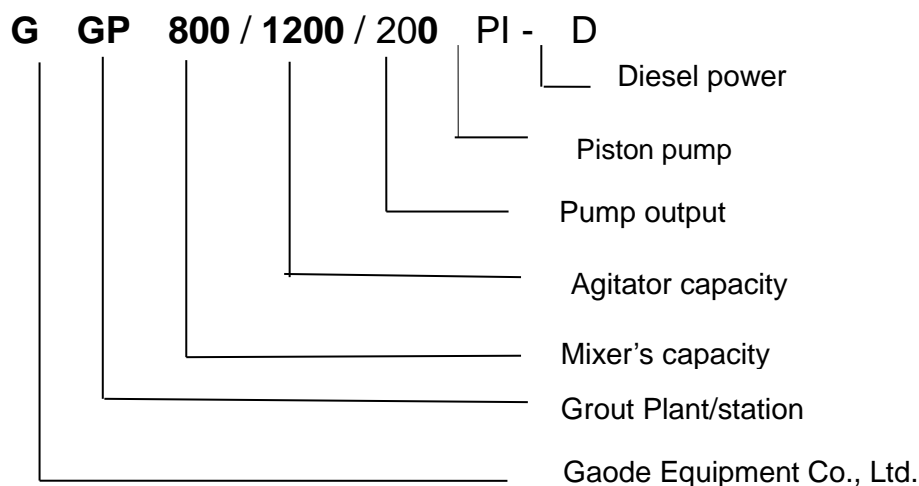



郑州高德机械设备有限公司
Gaode Equipment Co., Ltd.

地址 ADD: 郑州市金水区丰庆路 4 号院 14 号楼 9 号

邮编 P.C.:450053

No.9, Building 14, Yard No.4, Fengqing Road, Jinshui District, Zhengzhou, Henan China

网站 Web: www.gaodetec.com

邮箱 E-Mail: info@gaodetec.com

电话 TEL.:+86-371-55951210

传真 FAX:+86-371-55951210

Specification:

Description	Data
Grout Station model	GGP800/1200/200PI-D
Diesel engine (Air cooling, Deutz technology)	55kw, 2500r/min
Dimensions	3200*2200*2000mm
Weight	2460kg
Mixer	
Capacity	800L
Output	15m ³ /h
Suitable water/cement ratio	≥0.5:1
Motor model	CMZ2040
Rated Rev.	1500rpm
Agitator	
Capacity	1200L
Motor model	2w-400
Rated Rev.	54rpm
Pump	
Output	0-200L/min
Pressure	0-5MPa



郑州高德机械设备有限公司 Gaode Equipment Co., Ltd.

地址 ADD: 郑州市金水区丰庆路 4 号院 14 号楼 9 号

邮编 P.C.:450053

No.9, Building 14, Yard No.4, Fengqing Road, Jinshui District, Zhengzhou, Henan China

网站 Web: www.gaodetec.com

邮箱 E-Mail: info@gaodetec.com

电话 TEL.:+86-371-55951210

传真 FAX:+86-371-55951210

Pictures:

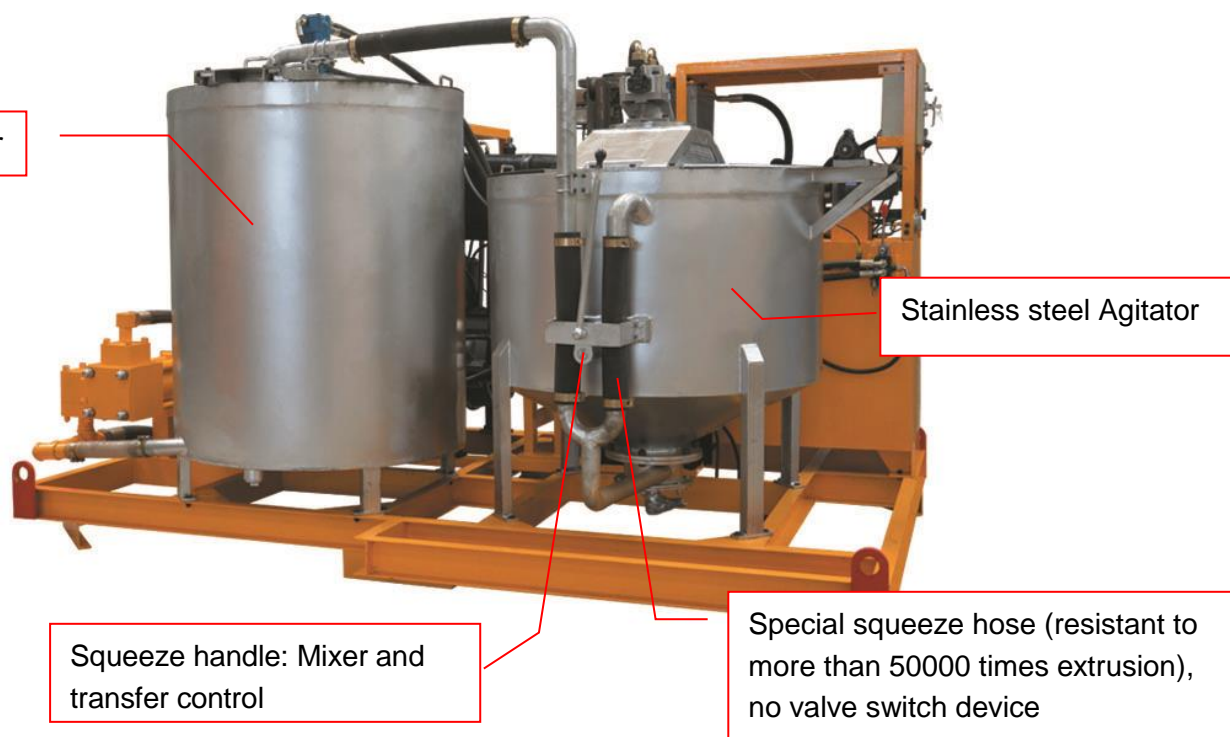
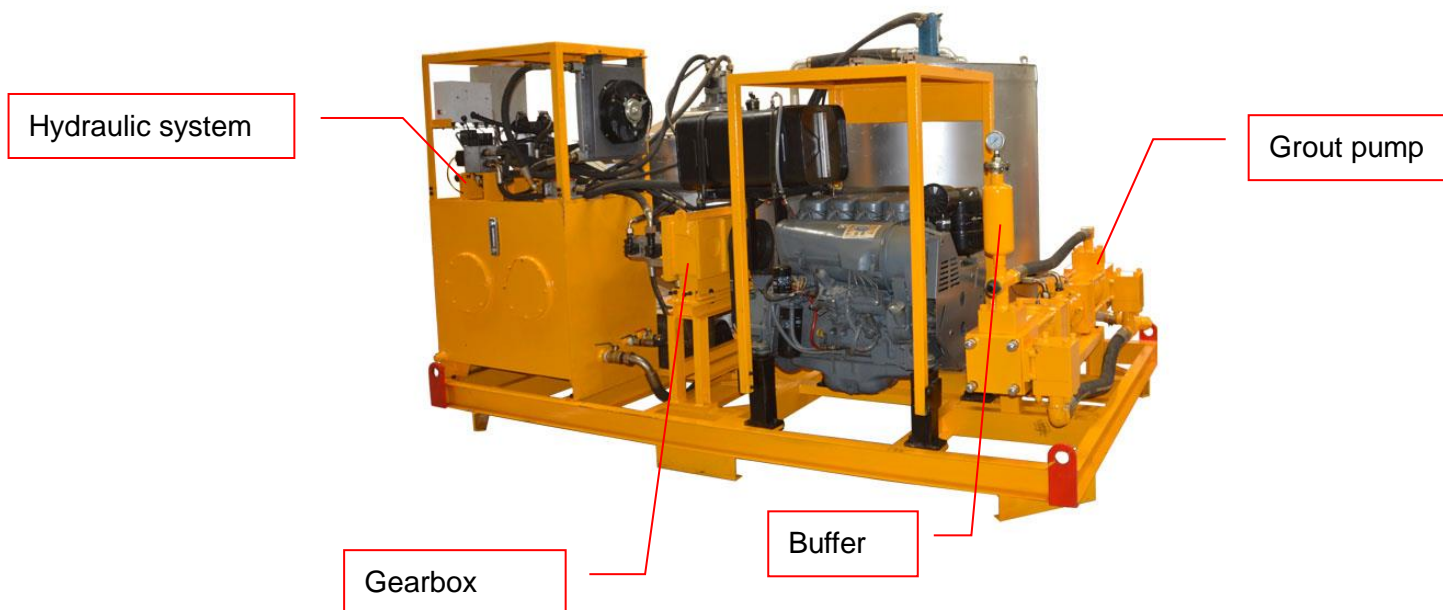



郑州高德机械设备有限公司 Gaode Equipment Co., Ltd.

地址 ADD: 郑州市金水区丰庆路 4 号院 14 号楼 9 号 邮编 P.C.:450053
No.9, Building 14, Yard No.4, Fengqing Road, Jinshui District, Zhengzhou, Henan China
网站 Web: www.gaodetec.com 邮箱 E-Mail: info@gaodetec.com
电话 TEL: +86-371-55951210 传真 FAX: +86-371-55951210

Grout pump: START

Cooling knob

Grout pump: OFF

Diesel engine start/stop switch: Turn right to start, diesel engine will start.

Manual directional control valve of Aaitator



Deutz technology: Powerful air cooling diesel engine





郑州高德机械设备有限公司 Gaode Equipment Co., Ltd.

地址 ADD: 郑州市金水区丰庆路 4 号院 14 号楼 9 号

邮编 P.C.:450053

No.9, Building 14, Yard No.4, Fengqing Road, Jinshui District, Zhengzhou, Henan China

网站 Web: www.gaodetec.com

邮箱 E-Mail: info@gaodetec.com

电话 TEL: +86-371-55951210

传真 FAX: +86-371-55951210



Newest design and easy
cleaning chamber

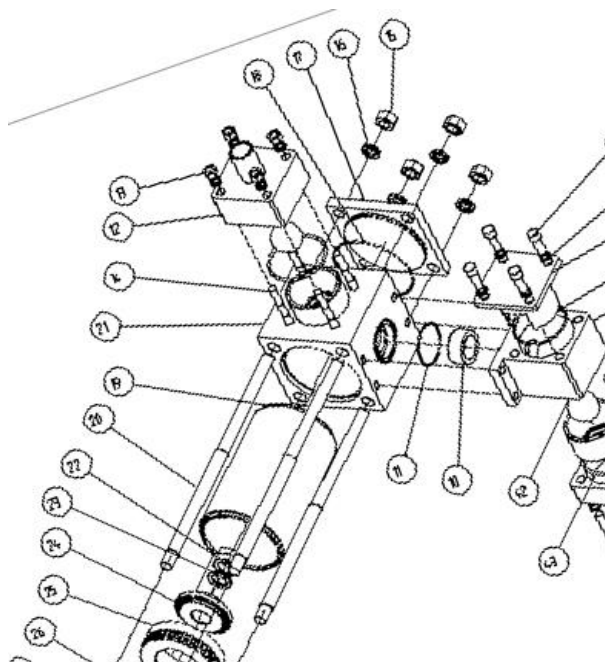

Newest design and easily
to replace the piston





郑州高德机械设备有限公司 Gaode Equipment Co., Ltd.

地址 ADD: 郑州市金水区丰庆路 4 号院 14 号楼 9 号

邮编 P.C.:450053

No.9, Building 14, Yard No.4, Fengqing Road, Jinshui District, Zhengzhou, Henan China

网站 Web: www.gaodetec.com

邮箱 E-Mail: info@gaodetec.com

电话 TEL.:+86-371-55951210

传真 FAX:+86-371-55951210

1

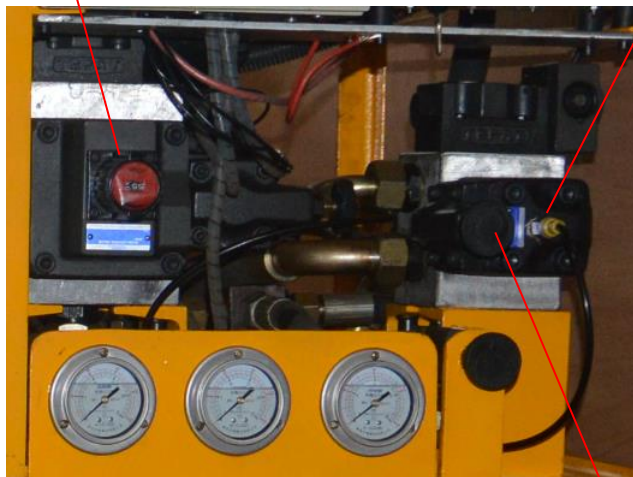

3



Manual directional control valve of mixer

2

1. Grouting pump speed regulating valve:
Clockwise rotation: grouting pump capacity increase;
Counterclockwise: grouting pump capacity decreases

2. Pressure regulator:
Clockwise rotation: grouting pump pressure increase;
Counterclockwise rotation: grouting pump pressure decreases

3. Overflow valve:
The overflow valve is used to prevent hydraulic system overload and protect oil pump etc.